

MAIN LEVEL FLOOR GROSS AREA - 990 sqft  
 MAIN LIVING AREA (MLA) - 1532 sqft  
 TOTAL LIVING AREA (TLA) - 2020 sqft

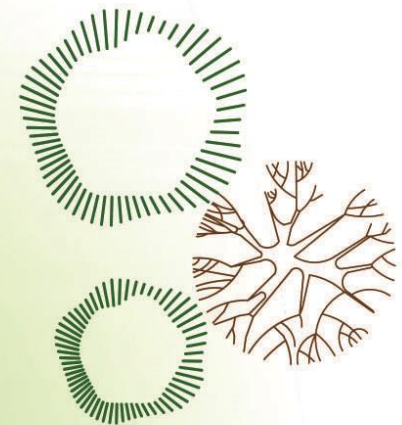

Main Level Floor Plan  
 157 The Point Road  
 Blue Rocks, NS

THIS DRAWING IS FOR REFERENCE ONLY,  
 NOT FOR CONSTRUCTION, DIMENSIONS NOT WARRANTED,  
 THIS DRAWING TO REMAIN PROPERTY OF ADAM & CINDY DIAL

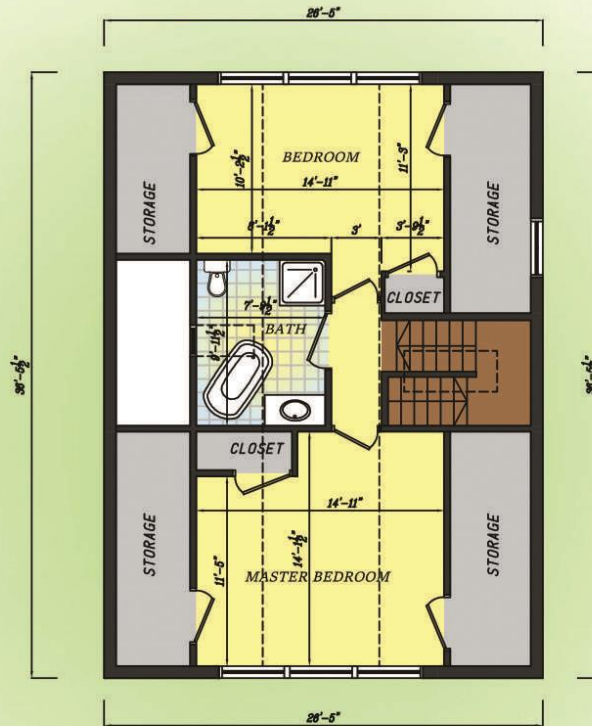
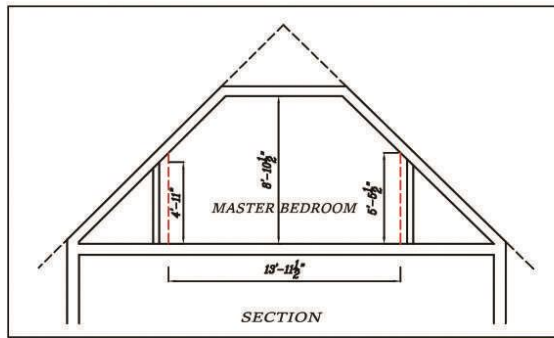

Upper Level Floor Plan  
157 The Point Road  
Blue Rocks, NS

THIS DRAWING IS FOR REFERENCE ONLY,  
NOT FOR CONSTRUCTION. DIMENSIONS NOT WARRANTED.  
THIS DRAWING TO REMAIN PROPERTY OF ADAM & CINDY DIAL

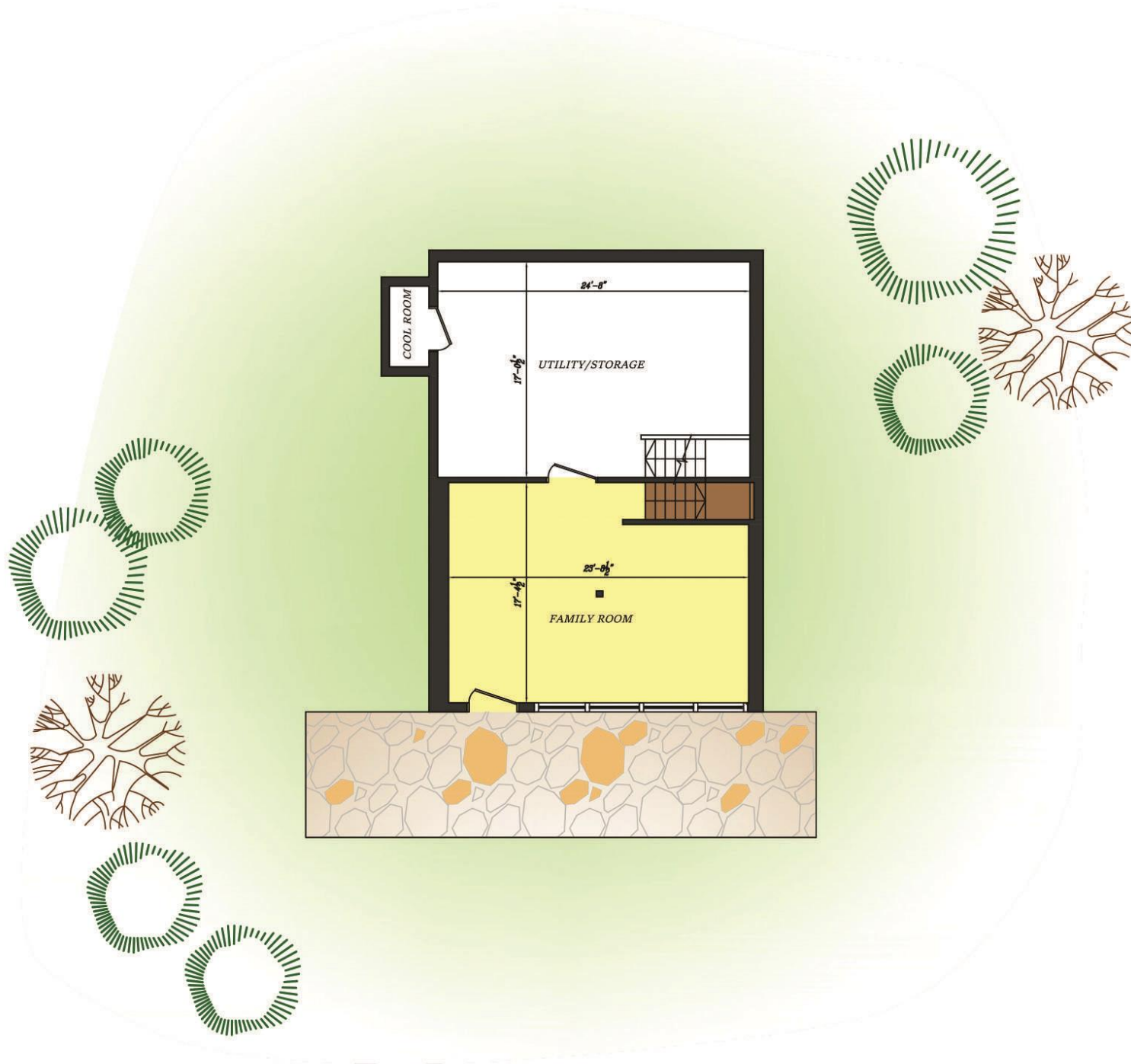

Lower Level Floor Plan  
157 The Point Road  
Blue Rocks, NS

THIS DRAWING IS FOR REFERENCE ONLY,  
NOT FOR CONSTRUCTION, DIMENSIONS NOT WARRANTED,  
THIS DRAWING TO REMAIN PROPERTY OF ADAM & CINDY DIAL